



Quality Assurance Keep Improving



TECHNOMET ENTERPRISES



Mail:

mahesh.bhattad@technometent.co.in
tme_pne@technometent.co.in
salestechnomet123@gmail.com



Contact No.:

+91-98500 87426
+91-98500 83743
+91-72760 91255

Address: 103, Varad Vinayak Complex, Sr.no. 26/1, Narhe, PUNE, 411041

www.technometent.co.in

Hollow Shaft



○Hollow shaft: the internal diameter and wall thickness can be customized according to customer requirements.

○ Material: GCr15 (SUJ2) , Rigidity: HRC60-62

the metric system of hollow shaft

Model No.	Inner Diameter (mm)	Outer Diameter (mm)	Diameter Tolerance (mm)		Hardend Depth
			g6	h6	
SP12	6	12	-0.006-0.017	0-0.011	0.6~1.5
SP13	6	13	-0.006-0.017	0-0.011	0.6~1.5
SP16	10	16	-0.006-0.017	0-0.011	0.8~2.0
SP20	13	20	-0.007-0.020	0-0.013	0.8~2.0
SP25	17	25	-0.007-0.020	0-0.013	0.8~2.0
SP30	20	30	-0.009-0.025	0-0.016	0.8~3.0
SP35	24	35	-0.009-0.025	0-0.016	0.8~3.0
SP40	30	40	-0.009-0.025	0-0.016	0.8~3.0
SP50	38	50	-0.009-0.025	0-0.016	0.8~3.0
SP60	48	60	-0.010-0.029	0-0.019	0.8~3.0

Cylinder Linear Rail (Linear Shaft) Series



Material: Gcr15
 Hardness: HRC62±2
 Accuracy: g6-g5
 Roughness: Ra0.4-0.8
 Depth of hardening layer: 0.8mm~3mm
 Max Length: 1000mm~7000mm
 Straightness: less than 5µm in 100mm
 Roundness: No more than 0.003mm
 Standard type S: Chrome Plated AS: Stainless Steel

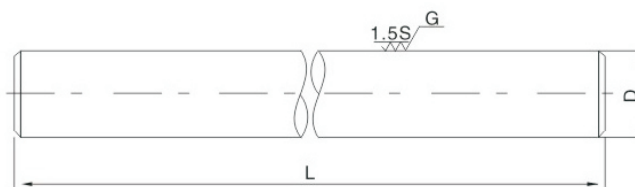

Dia (mm)	Model No.		Precision (µm)	Standard Length (mm)																			Effective Hardened Layer Depth	Weight (kg/m)	
	WC (WCAS)	WCS		g6	100	200	300	400	500	600	700	800	900	1000	1200	1500	1800	2000	2500	3000	3500	4000			5000
3	WC3	WCS3	-2~-8																					No more than 1.0	0.06
4	WC4	WCS4	-4~-12																						0.10
5	WC5	WCS5																							0.15
6	WC6	WCS6																							0.23
8	WC8	WCS8	-5~-14																					Not less than 1.0	0.40
10	WC10	WCS10	-6~-17																						0.62
12	WC12	WCS12																							0.89
13	WC13	WCS13	-7~-20																					Not less than 1.5	1.04
16	WC16	WCS16																							1.58
20	WC20	WCS20		-9~-25																					2.47
25	WC25	WCS25																							3.85
30	WC30	WCS30	-10~-29																					Not less than 2.0	5.55
35	WC35	WCS35																							7.55
40	WC40	WCS40		-12~-34																					Not less than 2.5
50	WC50	WCS50																						15.4	
60	WC60	WCS60	-14~-39																					Not less than 3.0	22.2
80	WC80	WCS80																							39.5
100	WC100	WCS100	-14~-39																					Not less than 3.0	61.7
120	WC120	WCS120																							88.8
150	WC150	WCS150																							139.0

Notice: 1. The model size with the mark ■ can be customized the length.
 2. We also supply 45# Carbon steel, 20CrMo and 40CrMo raw material type Shaft.

>>>Special Machining for Shaft

We can offer linear shaft with diameter $\Phi 5\text{mm} \sim \Phi 150\text{mm}$, maximum length up to 6000mm.

1. When you are special requirements on length, we can meet your machining requirements with different length; when you request above 6000mm, we can anti-connect for you. (shown in Fig a)

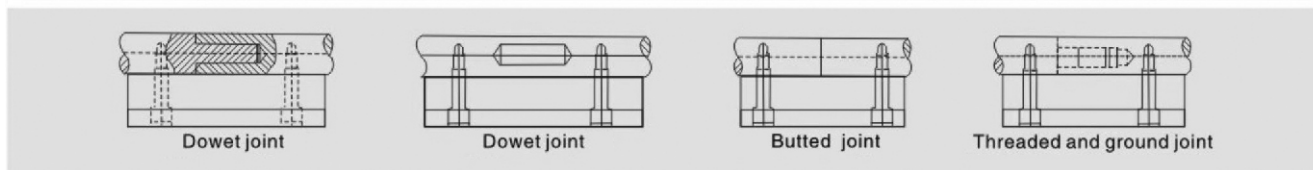

(Fig a)

2. When you are special requirements on machining, such as threading, coaxial holes drilled and tapped, radial holes drilled and tapped, reduced shaft diameter etc, we can machine for you, and these special machines are finished after heat treatment and hard chromic so that ensure the precision of product. send us your detailed sketch or blue print for propmt quotatine and action, your should be satisfied with our service.

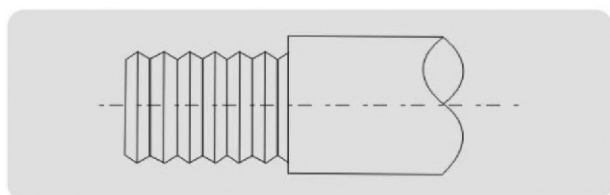

THREADING

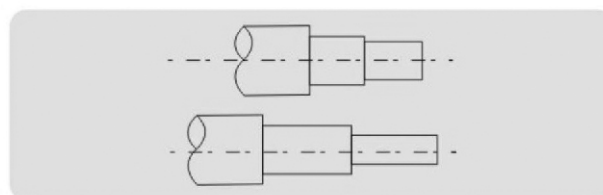

REDUCED SHAFT DIAMETER

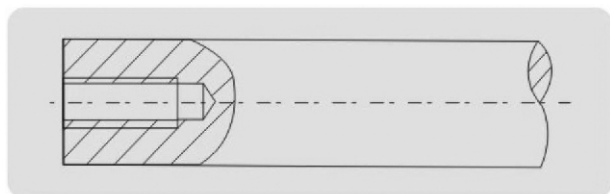

COAXIAL HOLES DRILLED AND TAPPED

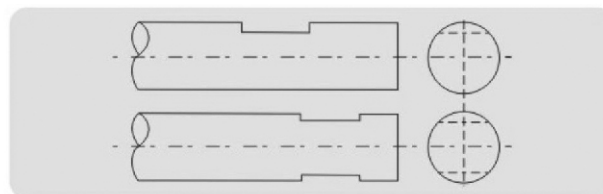

FLATS-SINGLE OR MULTIPLE

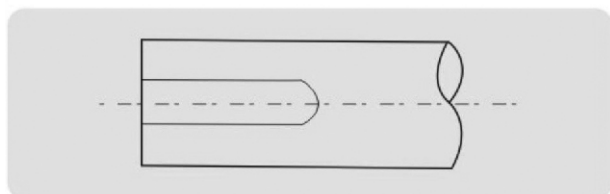

KEY WAY

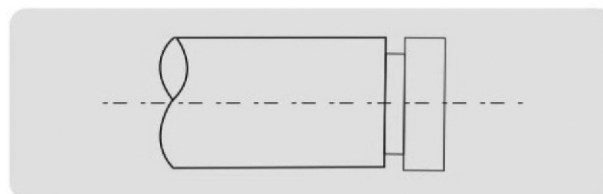

SNAP RING GROOVES

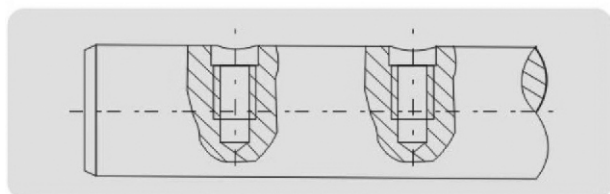

RADIAL HOLES DRILLED AND TAPPED

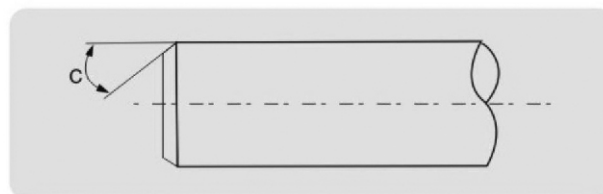

CHAMFERING